

LBK 鏜頭刀柄 LBK Boring Head Bar

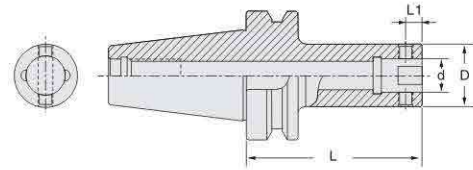

型號 Model	D	d	L ₁	L	側固錐度螺絲 Screw	單價 RMB
New! BT30 LBK1-40	19	11	5.05	40	SM4	240
LBK1-70	19	11	5.05	70		140
New! LBK1-105	19	11	5.05	105		240
LBK1-150	19	11	5.05	150		300
LBK2-40	24	14	6.62	40	SM5	240
New! BT30 LBK2-80	24	14	6.62	80		140
LBK2-115	24	14	6.62	115		240
LBK2-150	24	14	6.62	150		300
New! BT30 LBK3-40	31	18	8	40	SM6	240
New! LBK3-70	31	18	8	70		140
LBK3-80	31	18	8	80		140
LBK3-110	31	18	8	110		240
LBK3-150	31	18	8	150		300
BT30 LBK4-45	39	22	10	45	SM8	240
LBK4-70	39	22	10	70		140
LBK4-115	39	22	10	115		240
LBK4-150	39	22	10	150		300
New! LBK5-45	50	28	13	45	SM10	240
New! LBK5-60	50	28	13	60		140
LBK5-70	50	28	13	70		140
LBK5-125	50	28	13	125		240
BT30 LBK6-65	64	36	16	65	SM12	140
LBK6-115	64	36	16	115		240
New! BT40 LBK1-40	19	11	5.05	40		SM4
LBK1-75	19	11	5.05	75	140	
LBK1-105	19	11	5.05	105	160	
LBK1-130	19	11	5.05	130		190
New! LBK1-150	19	11	5.05	150		210
LBK1-165	19	11	5.05	165		240
LBK1-195	19	11	5.05	195		400
BT40 LBK2-40	24	14	6.62	40	SM5	240
LBK2-85	24	14	6.62	85		140
LBK2-115	24	14	6.62	115		160
New! LBK2-130	24	14	6.62	130		190
LBK2-145	24	14	6.62	145		210
LBK2-165	24	14	6.62	165		240
LBK2-200	24	14	6.62	200		400
BT40 LBK3-45	31	18	8	45	SM6	240
LBK3-95	31	18	8	95		140
LBK3-125	31	18	8	125		160
LBK3-155	31	18	8	155		210
New! LBK3-175	31	18	8	175		240
LBK3-185	31	18	8	185		240
New! LBK3-215	31	18	8	210		400
LBK3-250	31	18	8	250		500
New! LBK3-300	31	18	8	300		600
BT40 LBK4-45	39	22	10	45	SM8	240
LBK4-85	39	22	10	85		140
New! LBK4-100	39	22	10	100		160
LBK4-115	39	22	10	115		160
LBK4-130	39	22	10	130		190
New! LBK4-150	39	22	10	150		400
LBK4-155	39	22	10	155		210
LBK4-175	39	22	10	175		240
New! LBK4-205	39	22	10	205		450
LBK4-220	39	22	10	220		400
LBK4-250	39	22	10	250		500
New! LBK4-300	39	22	10	300		600
BT40 LBK5-45	50	28	13	45	SM10	240
LBK5-75	50	28	13	75		140
New! LBK5-100	50	28	13	100		160
LBK5-125	50	28	13	125		160
New! LBK5-150	50	28	13	150		210
LBK5-155	50	28	13	155		210
LBK5-175	50	28	13	175		240
LBK5-205	50	28	13	205		400
LBK5-235	50	28	13	235		450
New! LBK5-250	50	28	13	250		500
New! LBK5-285	50	28	13	285		700
BT40 LBK6-45	64	36	16	45	SM12	240
New! LBK6-55	64	36	16	55		140
LBK6-65	64	36	16	65		140
LBK6-115	64	36	16	115		160
LBK6-165	64	36	16	165		240
LBK6-200	64	36	16	200		400
New! LBK6-225	64	36	16	225		450
LBK6-250	64	36	16	250		500
LBK6-300	64	36	16	300		700

型號 Model	尺寸 Size(mm)			側固錐度螺絲 Screw	單價 RMB	
	D	d	L ₁			L
<i>New!</i> BT50 LBK1-80	19	11	5.05	80	SM4	400
LBK1-115	19	11	5.05	115		360
LBK1-145	19	11	5.05	145		400
LBK1-175	19	11	5.05	175		440
LBK1-205	19	11	5.05	205	504	
<i>New!</i> BT50 LBK2-50	24	14	6.62	50	SM5	400
<i>New!</i> LBK2-95	24	14	6.62	95		360
LBK2-115	24	14	6.62	115		360
<i>New!</i> LBK2-140	24	14	6.62	140		400
LBK2-145	24	14	6.62	145		400
LBK2-175	24	14	6.62	175		440
LBK2-205	24	14	6.62	205		504
LBK2-235	24	14	6.62	235	728	
<i>New!</i> BT50 LBK3-55	31	18	8	55	SM6	400
<i>New!</i> LBK3-95	31	18	8	95		360
LBK3-125	31	18	8	125		380
LBK3-135	31	18	8	135		380
LBK3-155	31	18	8	155		400
LBK3-185	31	18	8	185		440
LBK3-215	31	18	8	215		504
LBK3-255	31	18	8	255		616
LBK3-300	31	18	8	300		728
LBK3-350	31	18	8	350		1000
LBK3-400	31	18	8	400	1200	
<i>New!</i> BT50 LBK4-55	39	22	10	55	SM8	400
<i>New!</i> LBK4-90	39	22	10	90		360
LBK4-115	39	22	10	115		360
LBK4-145	39	22	10	145		400
<i>New!</i> LBK4-175	39	22	10	175		440
LBK4-205	39	22	10	205		504
LBK4-255	39	22	10	255		616
LBK4-300	39	22	10	300		728
<i>New!</i> LBK4-350	39	22	10	350		1000
LBK4-400	39	22	10	400		1200
BT50 LBK5-60	50	28	13	60	SM10	400
LBK5-90	50	28	13	90		360
LBK5-105	50	28	13	105		360
LBK5-150	50	28	13	150		400
LBK5-180	50	28	13	180		440
<i>New!</i> LBK5-205	50	28	13	205		504
LBK5-240	50	28	13	240		600
<i>New!</i> LBK5-270	50	28	13	270		660
LBK5-300	50	28	13	300		728
LBK5-350	50	28	13	350		1000
LBK5-400	50	28	13	400	1200	
LBK5-450	50	28	13	450	1400	
<i>New!</i> BT50 LBK5-500	50	28	13	500	1600	
<i>New!</i> BT50 LBK6-65	64	36	16	65	SM12	400
<i>New!</i> LBK6-95	64	36	16	95		360
LBK6-125	64	36	16	125		380
LBK6-150	64	36	16	150		400
LBK6-170	64	36	16	170		440
<i>New!</i> LBK6-175	64	36	16	175		440
LBK6-205	64	36	16	205		504
LBK6-230	64	36	16	230		580
LBK6-270	64	36	16	290		660
LBK6-290	64	36	16	270		728
<i>New!</i> LBK6-300	64	36	16	300		728
LBK6-350	64	36	16	350		1000
LBK6-400	64	36	16	400		1200
LBK6-450	64	36	16	450		1400
LBK6-500	64	36	16	500		1600
LBK6-550	64	36	16	550		1800
LBK6-600	64	36	16	600	2000	
LBK6-650	64	36	16	650	2200	
LBK6-700	64	36	16	700	2400	
LBK6-750	64	36	16	750	2800	
<i>New!</i> LBK6-800	64	36	16	800	3200	

BST鏢頭刀柄
BST Boring Heads Bar

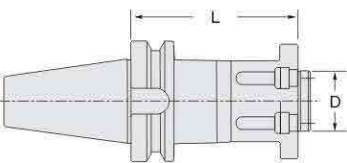

BST精鏢孔刀頭基礎柄系列(鏢孔範圍 > Φ200)
BST Basic holder for roughness and precision boring bar
(Boring range > Φ 200)

型號 Model	尺寸 Size(mm)		單價 RMB
	D	L	
<i>New!</i> BT40-BST-70	50	70	600
BT40-BST-100		100	440
BT40-BST-150		150	520
BT40-BST-200		200	700
BT50-BST-100		100	440
BT50-BST-150		150	520
BT50-BST-200		200	560
<i>New!</i> BT50-BST-225-BG		225	700
BT50-BST-250		250	700
<i>New!</i> BT50-BST-275-BG		275	800
BT50-BST-300		300	800
<i>New!</i> BT50-BST-325-BG		325	950
BT50-BST-350		350	900
<i>New!</i> BT50-BST-375-BG		375	1100
BT50-BST-400		400	1000
<i>New!</i> BT50-BST-425-BG		425	1300
BT50-BST-450	450	1300	
<i>New!</i> BT50-BST-475-BG	475	1600	

型號 Model	尺寸 Size(mm)		單價 RMB
	D	L	
BT50-BST-500	50	500	1600
<i>New!</i> BT50-BST-550		550	1800
<i>New!</i> BT50-BST-600		600	2000
<i>New!</i> BT50-BST-650		650	2200
SK40-BST-100		100	600
SK40-BST-150		150	800
SK50-BST-100		100	600
SK50-BST-150		150	800
SK50-BST-200		200	1000
SK50-BST-250		250	1200
SK50-BST-300		300	1400
NT50-BST-100		100	600
NT50-BST-150		150	800
<i>New!</i> NT50-BST-200-BG		200	1000
<i>New!</i> NT50-BST-250-BG		250	1200
<i>New!</i> NT50-BST-300-BG		300	1400
CAT50-BST-100	100	1200	
<i>New!</i> DAT50-BST-100	100	1200	